

and outer curve lock systems

Alternative integrated repositionable curve connection system maintains the highest level of alignment accuracy in both flat or curve configuration.

Curve connection blocks are available to support any increment of curve from -7.5 to +10 concave giving users unlimited design flexibility and control.

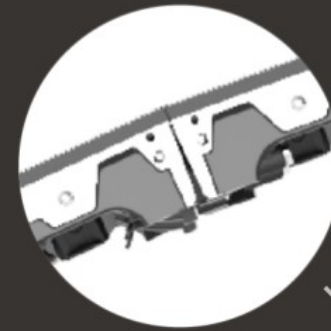

Fast rear service

Front & Rear serviceable with universal modules

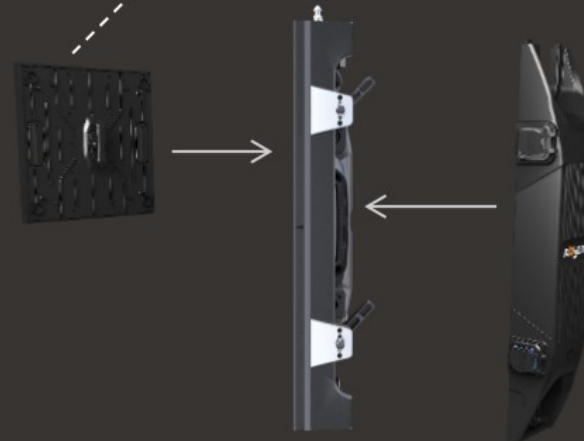

Quickly replace power core without tools

Four sides cutting cabinet



Absen four sides cutting cabinet is produced by a new die casting mould, which is robust and solid, it has a completed and stable cabinets structure.

On the one hand, we only need to assemble the connector/ sub connection plate to achieve the corner solution.

On the another hand, the application of four side cutting cabinet is more flexible than one side cutting cabinet.

Flexible application of four sides cutting cabinet:

a. 90 degree corner cabinet



b. LED cube. One side cutting cabinet is only available to achieve the LED cube.

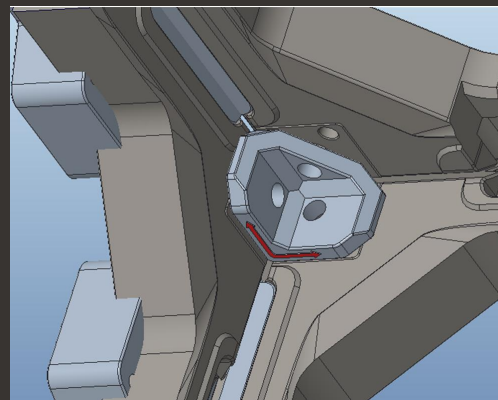

Flexible application of four sides cutting cabinet:

c. straight screen => the four side cutting cabinet can be connected with another four side cutting cabinet, and also with the normal cabinet.



the extra strip at the top and bottom side can be removed.



Shenzhen Absen Optoelectronic Co., Ltd.

PL2.5 Pro V10- Specifications

Version: V20221215

Parameter		Value
Physical Parameter	LED Type	Black SMD 3in1 1515
	Pixel Pitch (mm)	2.5
	Panel Dimensions (WxHxD)/(mm)	500x500x88
	Pixel Per Panel	200x200
	Panel Weight (kg)	8.6
	Panel Material	Die Casting Aluminum
	Module Dimensions (WxH)/(mm)	250x250
Optoelectronic Parameter	Brightness (nit)	1500
	Refresh Rate (Hz)	3840
	Gray scale (Bit)	16
	Contrast Ratio	8800:1
	Color Temperature (K)	6500
	Viewing Angle (H/V) (°)	160/140
	Driving Type	1/20
	AC Operating Voltage (V)	100~240
	Power Consumption (Max./Avg.)(W/m ²)	680/230
Application Parameter	Storage Temperature (°C)	-40~+60
	Operating Temperature (°C)	-10~+40
	Storage Humidity (RH)	10%~90%
	Operating Humidity (RH)	10%~90%
	IP Rating (Front/Rear)	IP40/IP21
	Module Maintenance	Front or Rear
	PSU & Others Maintenance	Rear
	Panel Installation Type	Hanging/Stacking
	Max Rigging QTY.	20
	Certificate	ETL,CE,ROHS,FCC

Remark: Power consumption tolerance: $\pm 15\%$, according to the actual situation.

SHENZHEN ABSEN OPTOELECTRONIC CO.,LTD 2001-2022 ALL RIGHTS RESERVED